

## Cordless Impact Wrench series



### TW010G

**3,150 N·m**

Square drive size  
**1" (25.4mm)**

Standard Bolt Size  
M27 - 45  
High strength Bolt Size  
M20 - 33



### TW001G

**1,800 N·m**

Square drive size  
**3/4" (19mm)**

Standard Bolt Size  
M12 - 36  
High strength Bolt Size  
M10 - 27



### TW007G

**760 N·m**

Square drive size  
**1/2" (12.7mm)**

Standard Bolt Size  
M10 - 24  
High strength Bolt Size  
M10 - 16



### TW004G

**350 N·m**

Square drive size  
**1/2" (12.7mm)**

Standard Bolt Size  
M10 - 20  
High strength Bolt Size  
M10 - 16



## Accessories

Impact socket  
with O-ring and pin



Impact deep socket  
with O-ring and pin



O ring  
E-22436



Pin  
E-22442



Size (mm)	Part No	Size (mm)	Part No
27 x 60	E-24511	42 x 68	E-24608
30 x 62	E-24527	44 x 70	E-24614
32 x 63	E-24533	46 x 72	E-24620
33 x 63	E-24549	50 x 76	E-24636
34 x 63	E-24555	55 x 84	E-24642
36 x 66	E-24561	60 x 88	E-24658
38 x 66	E-24577	65 x 92	E-24664
40 x 66	E-24583	70 x 96	E-24670
41 x 68	E-24599		

Size (mm)	Part No	Size (mm)	Part No
27 x 90	E-24686	44 x 90	E-24767
30 x 90	E-24692	46 x 100	E-24773
32 x 90	E-24701	50 x 100	E-24789
33 x 90	E-24717	55 x 108	E-24795
34 x 90	E-24723	60 x 108	E-24804
36 x 90	E-24739	65 x 120	E-24810
38 x 90	E-24745		
40 x 90	E-24751		
41 x 90	E-22420		

## Charging Time

	Fast Charging DC40RA	DC40RC
<b>BL4040</b> 4.0Ah 191B26-6	<b>45 min</b>	<b>67 min</b>
<b>*1 BL4040F</b> 4.0Ah 1910N6-8	<b>45 min</b>	<b>67 min</b>
<b>*1 BL4050F</b> 5.0Ah 191L47-8	<b>50 min</b>	<b>85 min</b>
<b>*1 BL4080F</b> 8.0Ah 191X65-8	<b>76 min</b>	<b>170 min</b>

\*1 Recommended battery

## Cordless Impact Wrench

### TW010G 1" (25.4 mm)

Variable Speed	Square drive	25.4 mm (1")
Brake	Anvil length	163 mm (6-3/8")
Reversing	Max fastening torque	3,150 N·m (2,323 ft.lbs.)
Electronic 4-Speed	Fastening torque	Max/ Hard / Med. / Soft: 2,850 / 1,600 / 1,000 / 600 N·m (2,100 / 1,180 / 740 / 440 ft.lbs.)
Built-in Job Light	Nut-busting torque	4,000 N·m (2,950 ft.lbs.)
Anti-restart function	Fastening capacities	Standard bolt: M27 - M45 (1-1/8 - 1-7/8") High strength bolt: M20 - M33 (3/4 - 1-3/8")
	No load speed	Max / Hard / Med. / Soft: 0 - 1,200 / 0 - 850 / 0 - 700 / 0 - 600 min <sup>-1</sup>
	Impacts per minute (IPM)	Max / Hard / Med. / Soft: 0 - 1,750 / 0 - 1,500 / 0 - 1,300 / 0 - 1,200
	Sound pressure level	103 dB(A)
	Sound power level	111 dB(A)
	Noise K factor	3 dB(A)
	Vibration level	33.4 m/s <sup>2</sup>
	Vibration K factor	1.6 m/s <sup>2</sup>
	Dimensions (L x W x H)	w/ BL4050F: 570 x 135 x 297 mm (22-1/2 x 5-5/16 x 11-3/4")
	Net weight	12.0 - 12.9 kg (26.5 - 28.4 lbs.)
	Net weight (Battery)	BL4040F - BL4080F

Standard Equipment : Side handle, Tool hanger (Ring), Battery, Charger

The weight may differ depending on the attachment(s), including the battery cartridge.  
Items of standard equipment and specifications may vary by country or area.

## Makita Singapore Pte Ltd

7, Changi South Street 3, Singapore 486348  
Phone : +65-6546-8700 Fax : +65-6546-8711  
Email : msgproductteam@makita.com.sg  
Website : www.makita.com.sg  
Facebook : www.facebook.com/MakitaSG



MakitaSG



VISIT OUR WEBSITE



DOWNLOAD LEAFLET

PRINTED IN SINGAPORE



## Cordless Impact Wrench TW010G 1" (25.4 mm)



**1" (25.4mm) square**

Max. fastening torque

**3,150 N·m**

6 seconds after seating, when tightening



Nut-busting torque

**4,000 N·m**

within 3 seconds, when loosening





## High power Brushless motor



## For tightening large diameter bolts

**1" (25.4mm) square**

**Max. fastening torque**  
**3,150 N·m**

6 seconds after seating, when tightening

**Nut-busting torque**  
**4,000 N·m**

within 3 seconds, when loosening



**Tool hanger (Ring)**  
allows to hang the tool  
on pipes, hooks, etc.

**Compact 570 mm\***



\*Overall length, with BL4050F

### Ring illumination LED

Reduces the shadow of the socket on a workpiece, providing a better view



### Toolless installation of Side handle

Side handle can be installed 360° without a tool, and the angle of the holding section can be adjusted back and forth, making it suitable for a variety



### Auto-stop system available in both forward / reverse rotation modes

3 modes of reaction time for automatic stop available both in forward and reverse rotation modes.

	Forward	Reverse
<b>mode 1</b>	At impact power 2, the tool stops automatically as soon as it has detected the first impact blow.	At impact power 4, the tool stops automatically as soon as it has stopped impact blow.
<b>mode 2</b>	At impact power 3, the tool stops automatically approximately 0.5 seconds after the moment it has detected the first impact blow.	At impact power 4, the tool stops automatically approximately 0.2 seconds after the moment it has stopped impact blow.
<b>mode 3</b>	At impact power 4, the tool stops automatically approximately 1.0 second after the moment it has detected the first impact blow.	At impact power 4, the tool automatically slows down after the moment it has stopped impact blow.

With regard to the reverse rotation mode (for loosening), the reaction time is set at the maximum impact power 4, which is the maximum capacity, because no adjustment of impact power is

### Electronic 4 stage impact power selection

Both in forward and reverse rotation modes, max (4) / hard (3) / medium (2) / soft (1) impact power can be selected to suit the material of workpiece or bolt type simply by pushing the button.

**Pushing the button**

Max mode (4) → Hard mode (3) → Medium mode (2) → Soft mode (1)

Mode	Max mode (4)	Hard mode (3)	Medium mode (2)	Soft mode (1)
Fastening torque (N·m)*1				
No load speed (min <sup>-1</sup> )				
Impacts per minutes (min <sup>-1</sup> )				

\*1 3 seconds after seating, when tightening

**XPT**  
(eXtreme Protection Technology)

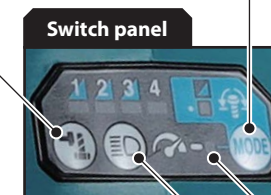

**Ring illumination LED switch**  
With preglow/afterglow functions and light mode

**Full speed mode lamp**

### Full speed mode button (Variable speed / Full speed)

- Full speed is reached with less trigger pull, reducing fatigue in continuous operation.
- Variable speed mode or Full speed mode can be selected depending on applications.

